



SFL

A Sphering Company

SELFLEX

Double Skin Multi Fuel
Flexible Chimney Liner



SELFLEX® is a high-quality double skin multi-fuel flexible chimney liner. Suitable for multi-fuel, gas and oil fired applications up to a maximum flue gas temperature of 600°C.



UK
CA

CE

www.sflchimneys.com



SELFLEX

Double Skin Multi Fuel Flexible Chimney Liner



A Sphering Company



Multi-Fuel
Appliances



Product
Warranty



125 & 150mm
Diameter



T600
Rating



Approved
Product



Quick
Installation



Brand
Compatibility



PRODUCT &
DOWNLOADS
QR CODE

SELFLEX® is a high-quality double skin multi-fuel flexible chimney liner suitable for multi-fuel, gas and oil fired applications up to a maximum flue gas temperature of 600°C. CE marked to EN 1856-2.

The SELFLEX® family range is suitable for the relining of masonry flues and use with wood and multi fuel stoves available in three different specifications:

- SELFLEX® is manufactured from corrosion resistant grade 316L stainless steel with a liner thickness of 0.1mm.
- SELFLEX® Plus is manufactured from corrosion resistant grade 316L stainless steel with a liner thickness of 0.12mm for extra strength.
- SELFLEX 904® is manufactured from a superior corrosion resistant grade 904 stainless steel. The 904 grade is recommended when burning smokeless fuels and where long periods are required as its more resistant to corrosive attack from mineral fuels.

SELFLEX® is available in a range of coiled lengths and is supported with a growing range of screw type adaptors, terminals, and ancillaries, specifically designed to ease installation and meet the demands of discerning installers.

Typical Applications

- Woodburning Stoves
- Multi-Fuel Stoves
- Commercial Boilers



UK
CA

CE

SELFLEX® Product Designations to BS EN 1856-1							
Product Description	Standard Number	Temperature Class	Pressure Class	D = Dry W = Wet	Corrosion Class	Material Specification Liner Grade 316L Liner Thickness 0.5	Sootfire Resistance G= Yes O= No
SELFLEX	BS EN 1856-1	T600	NI	W	V2	L50010	0
SELFLEX PLUS	BS EN 1856-1	T600	NI	W	Vm	L50012	0
SELFLEX 904	BS EN 1856-1	T600	NI	W	V2	L50010	0

Specification

Product Description	Class
Inner Liner	SELFLEX / SELFLEX PLUS: 316L (1.4404) Selflex 904 (1.4539)
Material Thickness	SELFLEX: 0.1MM SELFLEX PLUS: 0.12mm Selflex 904: 0.1mm
Temperature Rating	200°C (PI) & 600°C (NI)
Pressure Class	Positive (PI) / Negative (NI)
Condensate Resistant	Yes (PI)
Soot Fire Resistant	T600 Yes (NI Only)
Corrosion Class	V2

Diameters & Weight

Internal Diameter	External Diameter	Max Bend Radius	Weight (Kg) Per Mtr	
125mm	131mm	188mm	SELFLEX / SELFLEX 904: 0.917KG	SELFLEX PLUS 1.065KG
150mm	156mm	231mm	SELFLEX / SELFLEX 904: 1.129KG	SELFLEX PLUS 1.328KG



Prepackaged SELFLEX Coil Lengths

All versions of SELFLEX are supplied in standard 6m, 7m, 8m, 9m, 10m, 12m and 30m coiled cut lengths and shrink wrapped in polythene.



SELFLEX - 0.1mm 316L Flexible Liner - 15 year warranty

Size	6m	7m	8m	9m	10m	12m	30m
125	0520612	0520712	0520812	0520912	0521012	0521212	0523012
150	0520615	0520715	0520815	0520915	0521015	0521215	0523015

SELFLEX Plus - 0.12mm 316L Flexible Liner - Lifetime warranty

Size	6m	7m	8m	9m	10m	12m	30m
125	050612	0500712	0500812	0500912	0501012	0501212	0503012
150	0500615	0500715	0500815	0500915	0501015	0501215	0503015

SELFLEX 904 - 0.1mm 904 Flexible Liner - Lifetime warranty

Size	6m	7m	8m	9m	10m	12m	30m
125	0510612	0510712	0510812	0510912	0511012	0511212	0513012
150	0510615	0510715	0510815	0510915	0511015	0511215	0513015

Product Adaptors

SFLUE to SELFLEX Screw Adaptor



Size	A	Part Number
125	57	0593212
150	57	0593215

SELFLEX to SFLUE Screw Adaptor



Size	A	Part Number
125	65	0593512
150	65	0593515

NOVA to SELFLEX Screw Adaptor



Size	A	Part Number
125	68	0593312
150	68	0593315

SELFLEX to NOVA Screwed Anchor Plate



Size	A	B	C	D	Part Number
125	42	47	400	350	0593612
150	42	45	400	350	0593615

SELFLEX to NOVA Screw Adaptor



Size	A	Part Number
125	65	0593912
150	65	0593915



SELFLEX to SFLUE Screwed Anchor Plate

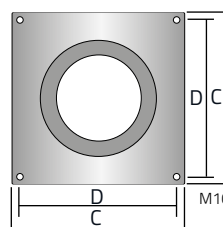

Size	A	B	C	D	Part Number
125	42	43	400	350	0593712
150	42	43	400	350	0593715

Product Adaptors

SVIT to SELFLEX Screw Adaptor



Size	A	B	Part Number
125	60	130	0593812
150	60	130	0593815

Plain End Screwed Adaptor

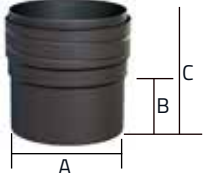

Size	A	B	C	Part Number
125	123	60	130	0593412
150	148	60	130	0593415

Sigma to Selflex Screw Adaptor



Size	A	B	Part Number
125	60	130	0593112
150	60	130	0593115

Sigma to Selflex 5" - 6" Increasing Adaptor



Size	A	B	Part Number
150	72	172	0592115

SVIT to Selflex 5" - 6" Increasing Adaptor



Size	A	B	Part Number
150	60	153	0592215

Selflex 5" - 6" Increasing Adaptor (Plain End)



Size	A	B	C	Part Number
150	123	72	172	0592015

Terminals

SELFLEX Standard Pot Hanging Screwed Terminal + Guard



Size	A	B	Part Number
125	300	166	0594312
150	300	166	0594315

SELFLEX Eurocowl Pot Hanging Screwed Anti-Downdraft Terminal



Size	A	B	Part Number
125	330	177	0595112
150	330	177	0595115

Ancillaries

Screwed SELFLEX Nose Cone



Size	Part Number
125	0505012
150	0505015

Top Insert



Size	A	Part Number
125	150	0595312
150	150	0595315

Top Plate + Clamp



Size	A	B	C	D	Part Number
125	400	350	380	40	0595212
150	400	350	380	40	0595215

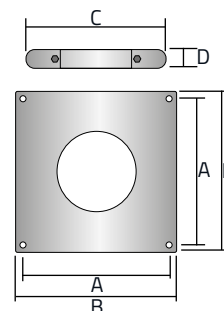

Warning: The length of Selflex suspended by a Screw Type component **MUST NOT** exceed more than 16 metres of product.



SELFLEX

Miscellaneous Flex Adaptors and Fittings

Used for generic connecting flue pipes and Flex Liners as well as compatible with the Selfflex range.

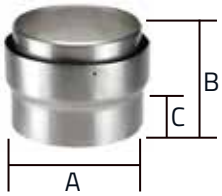

Flex Adaptor
Complete with fixing holes

Size	A	B	C	Part Number
125	120	123	60	FAI6005
150	145	123	60	FAI6006



Flex Adaptor - Bolted
Complete with 3no. hex head setscrews for easy fixing.

Size	A	B	C	Part Number
125	120	123	60	MAI-125
150	145	123	60	MAI-150

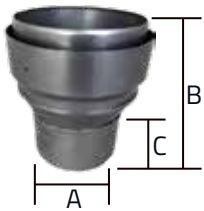

Flex Increasing Adaptor
Complete with fixing holes

Size	A	B	C	Part Number
125 - 150	120	183	62	IAI7006

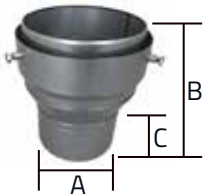

Increasing Adaptor (Bolted)
Complete with 3no. hex head setscrews for easy fixing.

Size	A	B	C	Part Number
125 - 150	120	183	62	MRI-125



Register Plate Adaptor
go connect single wall connecting pipe to flex via register plate for ease of installation

Size	Part Number
118	PAI7005
145	PAI7006

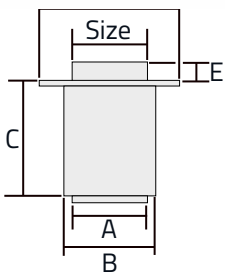

Size	A	B	C	D	E
118	118	140	165	234	33
145	145	167	165	234	33
125-150 Inc	145	167	170	234	46



The SELFLEX products are evolving. Keep an eye out at www.sflchimneys.com or through our social media channels for new product developments.

SVIT

Black Enamel Coated Connecting Flue Pipe

Applications

Multifuel stoves

Product Features

Fully welded
Smooth joint system
Extensive range of components

Technical Specification

Diameter - 125mm & 150mm
Construction - Single Wall
Material - 1mm Steel
Coating - 0.2mm Internal / External Enamel
Colour - Mat Black

Performance Specification - EN 1856-2

T600 N1 W V2 L80120 G(XX)

Where XX is 3 x ØInt of pipe

SVIT - Smooth Design Mat Black Enamelled

SVIT has been specifically designed as an enamel coated connecting flue pipe to facilitate connection between a multi-fuel appliance and either an existing masonry chimney, flexible multi-fuel liner or a prefabricated twin wall system chimney.

This product has been developed to offer a smooth aesthetically pleasing joint without the need of an additional locking band. Svit is manufactured from 1mm steel substrate and coated both internally and externally with a 0.2mm matt black enamel finish. Available in diameters 125mm and 150mm.



kiwa
Approved



0476-CPR-2977

SFLUE - Twin Wall Insulated Stainless Steel Twist Lock Chimney System

S-FLUE is a high quality twin wall flue system designed to suit multifuel appliances including gas, oil and wood burning. It has an extensive range of aesthetically pleasing components for the discerning homeowner.

With a specific range of components and a multi-barb twist-lock jointing system, SFLUE offers the ultimate in ease of installation and quality at a competitive price. It's a CE approved product and has been tested to the requirements of BS EN 1856-1.

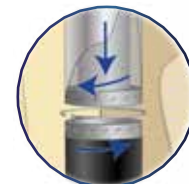
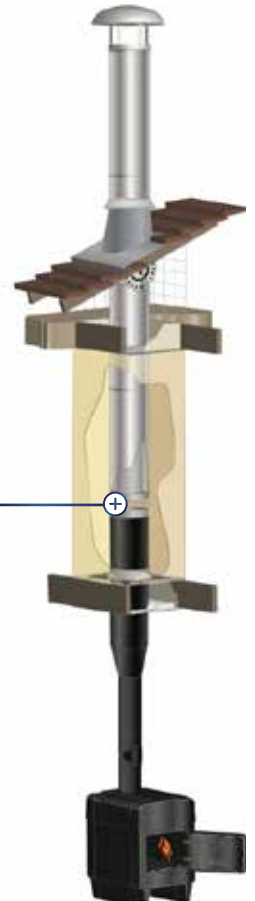

TWIST-LOCK
JOINTING SYSTEM



SFLUE

Twin Wall Insulated Stainless Steel Residential Multi Fuel System Chimney

Applications

Multi fuel stoves

Product Features

Fully welded
Fast twist-lock installation
High thermal resistance
High strength and durability
8 barb coupler for strength

Technical Specification

Diameter - 127mm-152mm
Construction - Twin Wall Insulated
Insulation Thickness - 25mm
Insulation Density - 250 Kg/m³
Inner Liner - Stainless steel 0.4mm 316L
Outer Case - Stainless steel 0.4mm 304BA

Performance Specification - EN 1856-1

T450 N1 D Vm L50040 G50



About us

Since 1969 we have provided expertise in system design and innovation for commercial, domestic and industrial applications, with uncompromised customer service. Our portfolio of trusted brands are known throughout the world for their engineering excellence.

SFL are owned by the Sphering Group, a main flue and air care industrial player in Europe with a renowned expertise in design, manufacturing and distribution of innovative high-quality chimney and ventilation systems.

We are proud of our British built heritage at SFL. All our products are fabricated at our manufacturing centre in Barnstaple, Devon, UK. As well as investment in the latest manufacturing system, we also have an extensive R&D centre ensuring continuous product development and testing to the latest European Standards.

Our Brands

SFL branded products are synonymous with the highest quality – it is this reputation that enables specifiers, contractors and house-holders to use our products with total confidence.

NOVA® SUPRA® EUROPA®

SIGMA® S-FLUE® IL® TUBEX®

SVIT® SELFLEX®

Head Office & Manufacturing Facility

SFL Flues & Chimneys
Pottington Business Park
Barnstaple
Devon
EX31 1LZ

Tel: +44 (0) 1271 326633
Email: info@sflchimneys.com
Web: www.sflchimneys.com



SFL pursues a policy of continuous improvement in both design and performance of its products and therefore reserves the right to change, amend or vary specifications without notice. Whilst the details contained herein are believed to be correct they do not form the basis of any contract and interested parties should contact the Company to confirm whether any material alterations have been made since publication of this brochure.