

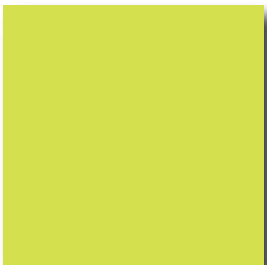

Technical data

Chimney fans, controllers & accessories

- solid-fuel and wood-burning stoves and fireplaces
- biofuel boilers
- decentralised multiple heating appliances connected to same chimney



Project and Design Support

exodraft solutions are so much more than just products and systems. In close co-operation with our **exodraft** Technology Centres we provide pre-sale analysis, system design and implementation recommendations.

During this process we use design software, developed by **exodraft**, which enables us to design any system with great accuracy and speed.

The design software allows **exodraft** and our Technology Centres' experienced engineers to design complete systems quickly, accurately and efficiently, whilst providing engineers with sizing reports.

As **exodraft** or our Technology Centres design the system, we also take full responsibility for its operation. This is part of **exodraft's** "Performance Guarantee".

System solutions with a perspective

exodraft's systems provide the basis for an optimal solution – both during planning and implementation. They are a reliable, simple solution for all professional partners.

Well-documented, our system solutions are adapted to meet the requirements and standards within the various areas of use.

We look forward to assisting you in getting started.

The **exodraft** Chimney Draught Systems are available through our network of **exodraft** Technology Centers (ETC), who distribute the full range of **exodraft** Chimney Draught Systems throughout the UK.

Each ETC has a certified **exodraft** product manager. The product manager is knowledgeable of **exodraft's** full Chimney Draught system and product range and will be able to answer all of your questions. All ETCs hold **exodraft** products in stock and items can usually be delivered within 24 hours.

All calculations and system recommendations provided by **exodraft** are performed in accordance with the relevant rules and regulations.

exodraft and our Technology Centres offer telephone engineering and installation support. All designs are stored electronically, so our engineers and technicians have a record of what a system looks like and what it includes.

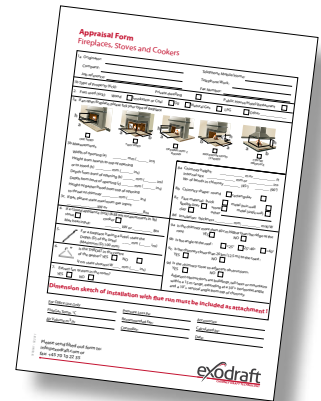

Want to know more about chimney fan solutions?

We have a number of CPD seminars that cover your business requirements in connection with the design of boiler systems and/or fireplaces.

Our seminars will help you to take full advantage of the possibilities that Mechanical Chimney Draught gives you to design energy efficient, flexible, and guaranteed safe boiler or fireplace systems.

Please feel free to contact us for further information on our CPD seminars or our Chimney Automation Solutions.

Peace of mind guarantee

exodraft systems are supplied with a peace of mind guarantee:

- 3 year warranty against any mechanical failure to the systems
- 10 year warranty against corrosion.

Table of contents

System descriptions

| | |
|--|---|
| Components for fireplaces or wood-burning stoves | 3 |
| Components for installations with multiple wood-burning stoves connected to the same chimney | 4 |
| Components for solid fuel or biomass-burning boilers | 5 |

Technical data

| | |
|--------------------------------|----|
| RS chimney fan | 6 |
| RSV chimney fan | 8 |
| EFC16 control | 10 |
| EFC35 control | 10 |
| EFC18 control | 11 |
| EW41 control | 12 |
| EBC20 control | 13 |
| Isolation switches | 14 |
| Flanges | 14 |
| Other installation accessories | 14 |

Installing the fans, service and maintenance

| | |
|--------------------------|----|
| Installing the fans | 15 |
| ‘Hiding’ the chimney fan | 15 |
| Service and maintenance | 15 |

Components for fireplaces or wood-burning stoves

With exodraft chimney fan systems you always have control over the chimney draught regardless of the weather conditions or other factors influencing the natural draught.

It is the function of the chimney both to remove the smoke and supply oxygen for effective combustion. In an ideal situation this is done through the natural chimney draught, but in reality both the chimney itself and other external factors affect the natural draught and thus the effectiveness of the chimney.

An **exodraft** chimney fan gives you complete control over the chimney draught. The chimney fan is installed on top of the chimney and creates a negative pressure in the flue, thus ensuring that the flue gases are extracted up the chimney rather than into the room. The fan control enables you to adjust the chimney draught to suit your needs, so you can enjoy the full comfort of a warm fireplace or wood-burning stove.

An **exodraft** chimney fan system for a fireplace or wood-burning stove consists of an RS or RSV chimney fan with an axial vane, a fan control and accessories.

The EFC16, EFC18, EFC35 & EW41 controls allow the user to manually adjust the chimney draught. The EFC18 control comes with a temperature sensor enabling automatic stop of the chimney fan after the fire is out. The EFC18 also has a boost function for extra chimney draught on start-up or when restoking the fire, so smoke downdraughts and odours do not escape into the room.

The EW41 wireless controller is easy to install as no power supply cables are needed for the control panel. In addition to having similar functionality as the EFC18, the EW41 also signals when it is time to restoke the fire and audibly indicates if the temperature inside the chimney becomes too high. It is easy to see and change the settings via the display on the control panel.

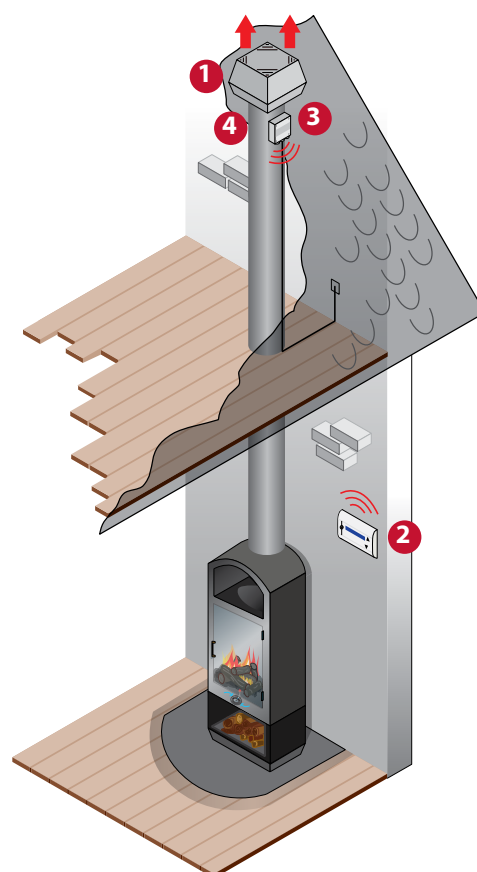

Find the components you need here:

| | Component | Type | Page |
|---|------------------------------|----------------------------|------|
| 1 | Chimney fan | RS with horizontal exhaust | 6 |
| | | RSV with vertical exhaust | 8 |
| 2 | Control | EFC16 | 10 |
| | | EFC35 | 10 |
| | | EFC18 | 11 |
| | | EW41 | 12 |
| 3 | Isolation switch | REP-AFB | 14 |
| | | REPSW2x16 | 14 |
| 4 | Accessories for Installation | Flange | 14 |

Components for a solid fuel or biomass-burning boiler

A natural draught chimney system is designed to work at average conditions for the region. So, when a solid fuel or biomass boiler is used all year round, the variable climatic conditions will sometimes lead to insufficient chimney draught. The use of a chimney fan system will ensure the correct chimney draught under any climatic conditions at all times.

When a biomass-burning appliance, for example a pellet stove, has chimney-draught problems, this can mean that lighting the fire can be difficult and may cause soot and smoke to be expelled back into the room. Insufficient chimney draught can also lead to poor combustion, and inefficient use of the fuel.

These problems can be solved by installing an **exodraft** chimney fan system, because the system ensures the correct chimney draught is available at all times.

An **exodraft** system for a solid fuel or biomass burning boiler consists of an RS or RSV chimney fan with axial blades, a controller and accessories. The EFC16, EFC18 or EFC35 controllers allow the user to manually adjust the chimney draught as needed. The EFC18 controller is supplied with a temperature sensor and will stop the chimney fan 45 minutes after the fire has gone out. It also starts the fan automatically if the preset temperature in the chimney has been reached by lighting the fire and the fan system has not been started manually. However, it is not recommended to light a fire unless the chimney fan is already in operation.

The EBC20 control regulates the fan speed automatically, maintaining constant pressure in the chimney and creating the optimal conditions to ensure correct combustion.

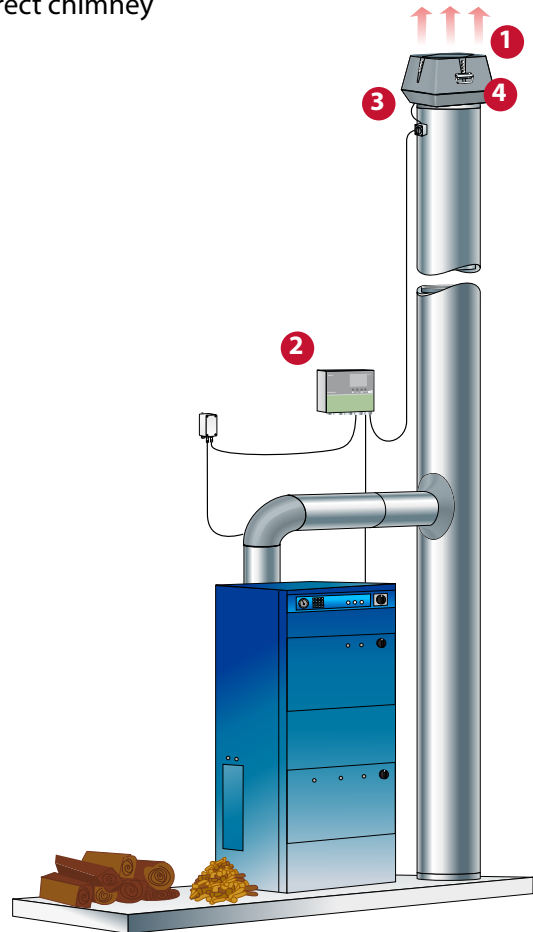

Find the components you need here:

| | Component | Type | Page |
|---|------------------------------|----------------------------|------|
| 1 | Chimney fan | RS with horizontal exhaust | 6 |
| | | RSV with vertical exhaust | 8 |
| 2 | Control | EFC16 | 10 |
| | | EFC35 | 10 |
| | | EFC18 | 11 |
| | | EBC20 | 13 |
| 3 | Isolation switch | REP-AFB | 14 |
| | | REPSW2x16 | 14 |
| 4 | Accessories for Installation | Flange | 14 |

RS chimney fan



Description

An **exodraft** RS chimney fan is a specially designed extractor fan with horizontal discharge.

The fans can be used with all types of fuel burning appliances and are especially well-suited to appliances burning solid fuel, such as biomass or solid-fuel boilers, fireplaces and wood-burning stoves.

The fan is installed on top of a chimney and creates a negative pressure (suction) along the full length of the flue and chimney.

The fan is part of an **exodraft** system and must be connected to an **exodraft** controller.

Design and construction

exodraft chimney fans are specially made to continuously withstand flue gas temperatures of up to 250 °C and continue functioning in dirty environments. They are constructed of corrosion resistant cast aluminium and the screws and bolts are made of stainless steel.

RS chimney fans are available in a range of sizes and capacities. The RS9, RS12, RS14 and RS16 models are equipped with stainless steel axial vanes for easy cleaning.

The RS chimney fan has a temperature resistant, entirely closed asynchronous motor, with ball bearings sealed for life. The motor is positioned away from harmful flue gases and is continuously cooled by a special cooling plate and cooling vents. The heat-resistant supply cable has cable-strain relief and is armoured. This all ensures that the chimney fan has a long and reliable working lifetime.

The chimney fan can be opened easily, so that a chimney sweep can sweep the chimney and clean the chimney fan without any problems. A safety mesh covers the radial discharge for protection.

RS technical data

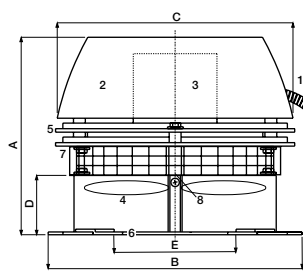

- | | |
|----------------|-------------------|
| 1. Motor cable | 5. Cooling plate |
| 2. Top section | 6. Base plate |
| 3. Motor | 7. Hinges |
| 4. Vane | 8. Locking screws |

| Model | Motor data | | | | Weight kg | Dimension (mm) | | | | |
|-----------|------------|---------|-----|------|--------------|----------------|-----|-----|-----|-----|
| | rpm | V | Amp | kW* | | A | B | C Ø | D | E Ø |
| RS009-4-1 | 1400 | 1 x 230 | 0,3 | 0,05 | 9 | 250 | 300 | 285 | 75 | 220 |
| RS012-4-1 | 1400 | 1 x 230 | 0,4 | 0,09 | 14 | 275 | 365 | 350 | 85 | 280 |
| RS014-4-1 | 1400 | 1 x 230 | 0,6 | 0,13 | 18 | 330 | 420 | 395 | 100 | 330 |
| RS016-4-1 | 1400 | 1 x 230 | 1,2 | 0,29 | 25 | 405 | 480 | 450 | 100 | 380 |

*Power consumption at ambient temperature of 20 °C

The RPM of the above fan models are infinitely adjustable

Motor protection IP rating IP54

Insulation class F

The RS9 and RS12 fans can also be supplied with an octagonal bottom section, specially designed for circular chimneys.

RS sound data

Sound levels to external surroundings
Lw (dB) measured in accordance to ISO 3744

| Model | Lw (dB) | | | | | | | Lp dB (A) |
|-----------|---------|--------|--------|---------|---------|---------|---------|-----------|
| | 125 Hz | 250 Hz | 500 Hz | 1000 Hz | 2000 Hz | 4000 Hz | 8000 Hz | |
| RS009-4-1 | 54 | 50 | 47 | 43 | 38 | 31 | 25 | 21 |
| RS012-4-1 | 64 | 60 | 55 | 52 | 48 | 42 | 34 | 30 |
| RS014-4-1 | 75 | 69 | 65 | 62 | 57 | 51 | 44 | 41 |
| RS016-4-1 | 81 | 76 | 72 | 69 | 64 | 58 | 52 | 47 |

Tolerance +/- 3dB.

Lw = sound effect level dB (reference: 1 pW)

Lp = sound pressure level dB (A) at 10 m distance from the fan at halfsperic sound distribution

Lp (5 m) = Lp (10 m) + 6 dB

Lp (20 m) = Lp (10 m) - 6 dB

RS capacity diagram

The capacity diagram shown below is only for illustration. Contact **exodraft** or your nearest dealer to calculate the correct fan size.

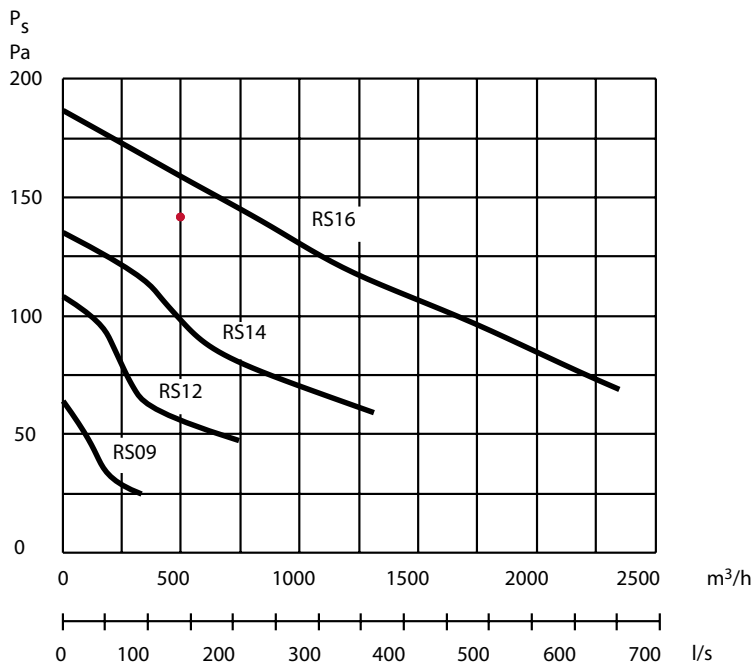

| Type | Test flue diameters |
|------|---------------------|
| RS09 | ø 160 mm |
| RS12 | ø 200 mm |
| RS14 | ø 250 mm |
| RS16 | ø 315 mm |

at 1400 rpm

PLEASE NOTE: The capacity diagrams are measured with a flue gas temperature of 20 °C. The fan's capacity changes with the temperature of the flue gases. The correction of the capacity can be calculated using the following equation:

$$P_{S_{20}} = P_{S_t} \times \frac{273 + t}{293}$$

P_S = static pressure
 t = temperature measured in °C

Example

System demand: 500 m³/h and 90 Pa at 180 °C

Fan selection: 500 m³/h and 139 Pa at 20 °C

RSV chimney fan



Description

An **exodraft** RSV chimney fan is a specially designed extractor fan with vertical discharge.

The fans can be used with all types of fuel burning appliances and are especially well-suited to appliances burning solid fuel such as biomass or solid-fuel boilers, fireplaces and wood-burning stoves.

The fan is installed on top of a chimney and creates a negative pressure along the full length of the flue and chimney.

The fan is part of an **exodraft** system and must be connected to an **exodraft** controller.

Design and construction

exodraft chimney fans are specially made to continuously withstand flue gas temperatures of up to 250 °C and continue functioning in dirty environments. They are constructed of corrosion resistant cast aluminium and the screws and bolts are made of stainless steel.

The RSV9, RSV12, RSV14 and RSV16 models are equipped with axial stainless steel vanes. The RSV250, RSV315 and RSV400 models are equipped with a cast aluminium centrifugal impeller and are used for larger installations, where multiple fireplaces are connected to the same chimney.

The RSV chimney fan has a temperature resistant, entirely closed asynchronous motor, with ball bearings sealed for life. The motor is positioned away from harmful flue gases and is continuously cooled by a special cooling plate and cooling vents. The heat-resistant supply cable has cable-strain relief and is armoured. This all ensures that the chimney fan has a long and reliable working lifetime.

The chimney fan can be opened easily, so that a chimney sweep can sweep the chimney and clean the fan without any problems. The exhaust vent has a protective stainless-steel grille.

RSV technical data

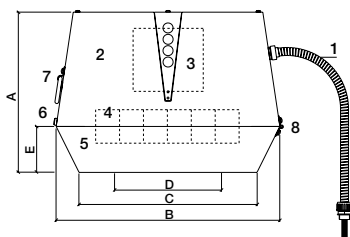

1. Connecting cable
2. Top section
3. Motor
4. Vane/centrifugal impeller

5. Bottom section
6. Locking screws
7. Handle
8. Hinges

| Model | Motor data | | | | Weight kg | Dimension (mm) | | | | |
|------------|------------|---------|-----|------|--------------|----------------|-----|-----|-----|-----|
| | rpm | V | Amp | kW* | | A | B | C Ø | D | E Ø |
| RSV009-4-1 | 1400 | 1 x 230 | 0,2 | 0,05 | 13 | 250 | 310 | 240 | 215 | 70 |
| RSV012-4-1 | 1400 | 1 x 230 | 0,4 | 0,07 | 17 | 280 | 390 | 310 | 275 | 80 |
| RSV014-4-1 | 1400 | 1 x 230 | 0,8 | 0,16 | 24 | 335 | 485 | 385 | 335 | 100 |
| RSV016-4-1 | 1400 | 1 x 230 | 1,8 | 0,32 | 35 | 380 | 580 | 465 | 365 | 115 |
| RSV250-4-1 | 1400 | 1 x 230 | 0,8 | 0,16 | 27 | 335 | 485 | 385 | 250 | 100 |
| RSV315-4-1 | 1400 | 1 x 230 | 1,8 | 0,37 | 37 | 380 | 580 | 465 | 315 | 115 |
| RSV400-4-1 | 1400 | 1 x 230 | 2,9 | 0,60 | 47 | 430 | 650 | 525 | 400 | 130 |

*Power consumption at ambient temperature of 20 °C
 The RPM of the above fan models are infinitely adjustable
 Motor protection IP rating IP54
 Insulation class F

RSV sound data

Sound levels to external surroundings
Lw (dB) measured in accordance with ISO 3744

| Model | Lw (dB) | | | | | | | Lp dB (A) |
|------------|---------|--------|--------|---------|---------|---------|---------|-----------|
| | 125 Hz | 250 Hz | 500 Hz | 1000 Hz | 2000 Hz | 4000 Hz | 8000 Hz | |
| RSV009-4-1 | 57 | 55 | 54 | 49 | 40 | 35 | 26 | 26 |
| RSV012-4-1 | 64 | 62 | 61 | 55 | 51 | 46 | 40 | 33 |
| RSV014-4-1 | 71 | 70 | 68 | 61 | 56 | 50 | 44 | 40 |
| RSV016-4-1 | 76 | 76 | 70 | 65 | 60 | 55 | 49 | 44 |
| RSV250-4-1 | 64 | 68 | 66 | 65 | 61 | 49 | 45 | 41 |
| RSV315-4-1 | 71 | 75 | 70 | 73 | 68 | 57 | 52 | 48 |
| RSV400-4-1 | 76 | 80 | 75 | 79 | 74 | 62 | 57 | 53 |

Tolerance +/- 3 dB

Lw = sound effect level dB (reference: 1 pW)

Lp = sound pressure level dB (A) at 10 m distance from the fan at halfsperic sound distribution

Lp (5 m) = Lp (10 m) + 6 dB

Lp (20 m) = Lp (10 m) - 6 dB

RSV capacity diagrams

The capacity diagrams shown below are only for illustration. Contact **exodraft** or your nearest dealer to calculate the correct fan size.

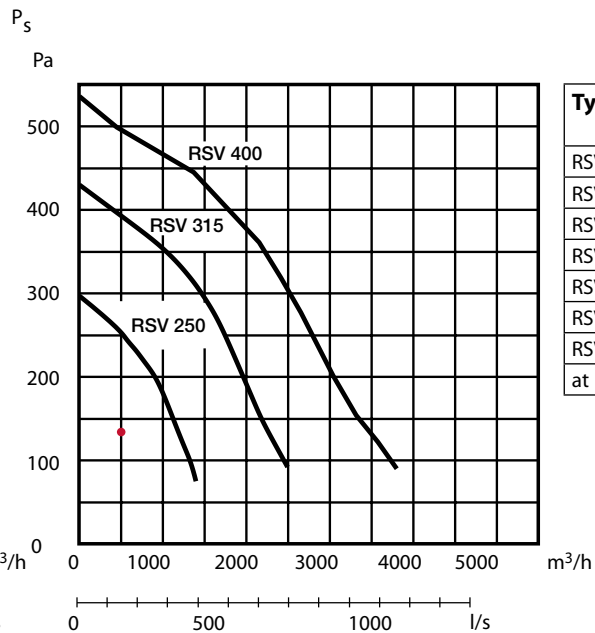
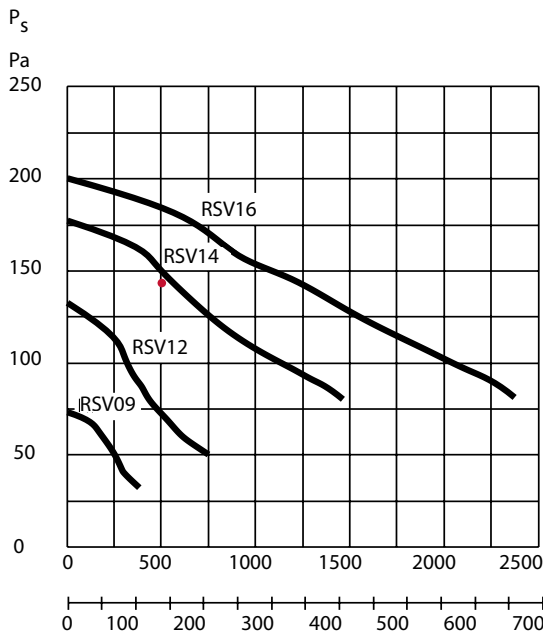

| Type | Test flue diameters |
|--------|---------------------|
| RSV09 | ø 160 mm |
| RSV12 | ø 200 mm |
| RSV14 | ø 250 mm |
| RSV16 | ø 315 mm |
| RSV250 | ø 250 mm |
| RSV315 | ø 315 mm |
| RSV400 | ø 400 mm |

at 1400 rpm

PLEASE NOTE: The capacity diagrams are measured with a flue gas temperature of 20 °C. The fan's capacity changes with the temperature of the flue gases. The correction of the capacity can be calculated using the following equation:

$$P_{S_{20}} = P_{S_t} \times \frac{273 + t}{293}$$

P_S = static pressure
 t = temperature measured in °C

Example

System demand: 500 m³/h and 90 Pa at 180 °C

Fan selection: 500 m³/h and 139 Pa at 20 °C

EFC16 & EFC35 manual controls



EFC16



EFC35

Description

EFC16 and EFC35 are electronic speed regulators used to manually control **exodraft** chimney fans.

The EFC16 or EFC35 speed regulators adjust the chimney fan's speed, thereby making it possible to control the chimney fan's capacity (draught) in the range 25–100%.

The speed regulators have a built-in ON/OFF switch in the control knob, a built-in minimum-speed trimmer, and an LED to indicate operation. They are CE-certified.

Function

The EFC16 and EFC35 speed regulators are designed for manual control. When the knob on these controllers is turned to the right, it will click and the fan will turn on at full rpm. As the knob is rotated clockwise, the fan speed will be reduced. To turn the fan off, the knob must be turned all the way anti-clockwise, until it has passed the on/off point again.

EFC16 or EFC35 control units must have a REP-AFB isolation switch mounted on the chimney. The isolation switch must be installed by an authorised electrician.

EFC16 & EFC35 technical data

| Description | EFC16 | EFC35 |
|---|----------------------------|----------------|
| Design | EPUS | - |
| Height (mm) | 85 | 102 |
| Width (mm) | 85 | 74 |
| Depth (mm) | 52 | 67 |
| Load (Amp) | Max. 1.5 A | Max. 3.5A |
| Fuse (Amp) | T 1.6 A | T 4 AH |
| Power supply | 230 VAC, 50 Hz | 230 VAC, 50 Hz |
| Ambient temperature | 0–40°C | 0–35°C |
| IP-rating | IP30 | IP30 |
| Casing material | ABS | ABS |
| Colour | White | White |
| Usable with the following fans listed in this brochure: | RS9/12/14/16 RSV9/12/14 | RSV16 |

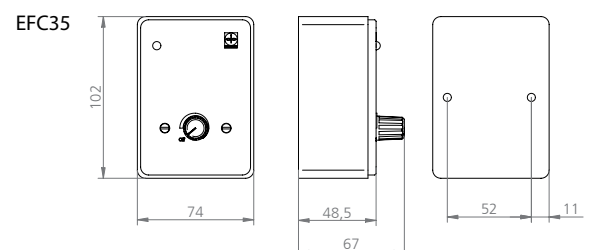
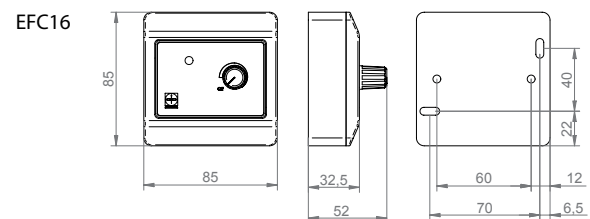

EFC18 manual/automatic control



EFC18



Temperature sensor

Description

The EFC18 is a manual nine-step speed regulator with an integrated automatic START/STOP for the **exodraft** chimney fan. It also features a boost function, to make lighting the fire easier. The EFC18 controller comes with a temperature sensor to be fitted under the fan.

Function

The EFC18 controller switches the chimney fan on with a simple press of a button on the control panel. To ensure sufficient up-draught when lighting the fire, the fan will run at full speed for the first seven minutes unless turned down manually. After the start up period the fan will modulate down to the speed it was running the last time it was in operation.

When restoking the fire, press the operating button once. The EFC18 control will then run the fan in boost mode for three minutes so that no smoke or dust will escape into the room while the fire is restoked.

The EFC18 temperature sensor, which is installed under the chimney fan, registers falling temperature. As the fire dies out and the flue temperature drops, the controller will (at a preset temperature of 20, 40 or 80°C) run the fan for 45 minutes before stopping the fan. This ensures that all the material in the fire has combusted. The temperature sensor will also ensure that the fan is automatically started if a chimney temperature above a set level is registered.

The fan speed can always be adjusted manually during operation, but the temperature sensor will prevent the fan from being turned off while the fire is still burning and thereby avoid damaging the fan motor and eliminate the risk of spillage.

A REPSW2x16 isolation switch must be fitted to the chimney when the EFC18 control system is installed. The isolation switch must be installed by an authorised electrician.

EFC18 technical data

| Description | EFC18 |
|---|-----------------------------|
| Height (mm) | 85 |
| Width (mm) | 85 |
| Depth (mm) | 32.5 |
| Load (Amp) | 1.2 A |
| Fuse (Amp) | T 1.25 A |
| Power supply | 230 VAC, 50 Hz |
| Temperature sensor range | -50°C to +400°C |
| Ambient temperature | 0–40°C |
| IP-rating | IP30 |
| Casing material | ABS |
| Colour | White |
| Usable with the following fans listed in this brochure: | RS9/12/14/16 and RSV9/12/14 |

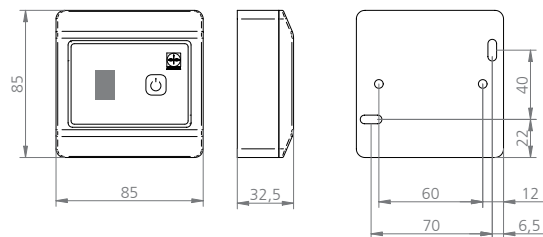

EW41 wireless control



EW41

Power Unit &
Temperature sensor

Optional Accessories

- Installation kit for steel chimneys.
- Mains adapter (230 V) for the control panel.
- Repeater unit to maintain signal strength for those installations where the control panel and power unit are placed far away from each another.

EW 41 technical data

| Description | Data |
|-----------------------------|----------------------------|
| EW41 | |
| Frequency | 868,42 MHz |
| Protocol | Z-wave |
| Range | Up to 12 m inside building |
| Control box | |
| Dimensions (w x h x d) | 122 x 120 x 55 mm |
| Material | ABS |
| Ingress Protection | IP64 |
| Voltage | 230 V \pm 10 %, 50 Hz |
| Fuse | T 2.0 |
| Current out | 2 ampere |
| Operating temperature | -30 °C til 60 °C |
| Temperature sensor | -50 °C til 450 °C |
| Power Consumption (standby) | 1 W |
| Control panel | |
| Dimensions (w x h x d) | 130 x 100 x 44 mm |
| Material | ABS |
| Operating temperature | 0 °C til 40 °C |
| Ingress Protection | IP20 |
| Battery | 4 stk AA (LR6) |
| Battery lifetime | approx. one year |

Description

The wireless control EW 41 from **exodraft**, is used to regulate chimney fans for solid fuel fires, such as open fires or wood-burning stoves.

EW 41 consists of:

- a control panel
- a control box with fan repair switch and 5 m cable that plugs into the mains
- a temperature sensor to be placed under the fan (Must be connected to the control box)

The EW41 control panel lets you start and stop the fan or regulate its speed. The panel saves the last operating setting and you can read the consumption data in the display.

The temperature sensor automatically monitors the system's temperature to prevent possible overloading caused by omission. When the fire is lit, the system will switch on automatically even if you do not activate the EW41. Once the fireplace is cold, the fan turns off automatically, so the heat from the dwelling is not sucked away.

EW41 boosts the chimney draught for seven minutes. So lighting the fire is quick and easy.

The controller signals when it is time to restoke the fire. Once you have stoked the fire, the panel is activated and chimney draught is increased for three minutes. This prevents unpleasant smoky downdraughts and your fire lights faster.

The control panel monitors chimney draught and triggers the alarm if:

- the repair switch is switched off
- the fan power fails
- there is no connection to the control box
- there is risk of a chimney fire because chimney temperature is too high.

The EW 41 controller uses radio wave (Z-wave) communication, which is a very safe system as all commands are confirmed and there is no risk of interference from other equipment.

EBC20 automatic control



EBC20



XTP sensor

EBC20 technical data

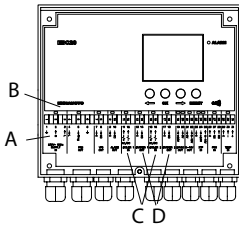

| Description | Data |
|---|------------------------------|
| EBC20EU01 | |
| Height x width x depth | 204.3 x 239.5 x 77.2 mm |
| Weight | 1.62 kg |
| IP-rating / material | IP54 / ABS PA758 |
| Voltage (A) | 230 VAC ±10%, 50 Hz ±1% |
| Power consumption | 475 W (3,7 A) |
| Fuse (B) | T4A |
| Temperature | -20°C to +60°C |
| Monitoring range | -500 to +500 Pa |
| XTP sensor | |
| Dimension (w x h x d) | 75 x 92 x 49 mm |
| Operating temperature | 0 to 70°C |
| Monitoring range | 0 to +150 Pa |
| Max. distance btw. EBC20 and XTP sensor | 100 m |
| IP-rating | IP54 |
| EBC20EU01 Inputs | |
| Digital inputs (D11 & D12) (C) | 18-230 V AC/DC |
| Pressure sensor (XTP) input | 0 to 10 VDC, 20 mA |
| Pressure switch (PDS) input | 24 VDC, 20 mA |
| EBC20EU01 Outputs | |
| Digital relay outputs (DO1 & DO2) (D) | 250 VAC, 8 A, AC3 |
| Motor regulator | Supply voltage -3%, 3 A, AC3 |
| Motor start/stop relay | 250 VAC, 8 A, AC3 |
| Control signal 0-10 VDC | 20 mA |
| 24 VDC power supply | 100 mA |
| Alarm output relay | 250 VAC, 8 A, AC3 |

Description

The EBC20 is an automatic control system for boiler installations and for other installations in which multiple heat sources are connected to the same chimney. The control monitors and maintains a specific draught by maintaining a constant pressure.

The control may only be used with **exodraft** fans. The EBC20 system consists of an EBC20 controller, which can be positioned anywhere, and a pressure transducer (XTP sensor) which is positioned in the chimney.

Function

In installations where several fireplaces or stoves are connected to the same chimney, the chimney fan operates continuously. The EBC20 controller monitors and maintains a specific draught by maintaining a constant pressure. The pressure in the chimney is measured by the XTP sensor. If the draught falls below the set value, the speed of the chimney fan is regulated until the draught reaches the required level again.

The EBC20 is usable with all **exodraft** chimney fan types.

Isolation switch



REP-AFB



REPSW2x16

It is a legal requirement that an isolation switch is installed in the immediate vicinity of the chimney fan, so that, for example, chimney sweeps can disconnect the electrical current to the chimney fan. The type of isolation switch required depends on the chimney fan control system.

| Type | Description | Used with controls |
|-----------|---------------------------|----------------------------|
| REP-AFB | 2-pole isolation switch | EFC16, EFC35, EW41*, EBC20 |
| REPSW2x16 | 4-pole** isolation switch | EFC18 |

* EW41 is delivered with the repair switch

** 3-pole with help switch

FR flange

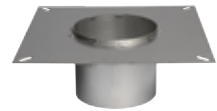

FR



FR-02

FR flanges from **exodraft** are used to install **exodraft** chimney fans on steel chimneys.

The flanges are made of stainless steel and ensure that the chimney fans have a flat and level installation base. The flange is supplied with four vibration dampers that reduce vibrations and help create a stable base for the chimney fan.

The diameter of the flange spigot is 3 mm smaller than the diameter of the chimney. For example, the diameter of the spigot of an FR1-200 is Ø 197 mm, designed to fit into a chimney opening with a Ø 200 mm diameter.

The flange range caters for all types of chimney fans and chimneys. Flanges with diameters other than those shown in the table can be made to order.

| Type | mm | Chimney diameter | Chimney fan |
|--------|-----------|-----------------------------------|-------------------------------------|
| FR1 | 240 x 240 | 125 - 150 - 175 - 200 | RSV9, RSV160 |
| FR2 | 310 x 310 | 125 - 150 - 175 - 200 - 250 | RSV12, RSV200, RS9, RS255 |
| FR3 | 395 x 395 | 150 - 175 - 200 - 250 - 300 - 350 | RSV14, RSV250, RS12, RS14, RS285 |
| FR4 | 500 x 500 | 200 - 250 - 300 - 350 - 400 - 450 | RSV16, RSV315, RSV400, RSV450, RS16 |
| FR2-02 | 310 x 310 | 150-160-200 | RS009-4-1-02 |
| FR3-02 | 395 x 395 | 150-200 | RS012-4-1-02 |

Spigot length 120 mm

Other fitting accessories



Four levelling screws type RSD can be installed between the fan and the chimney to create dilution air in brick chimneys if the temperature in the chimney is too high. If dilution air is required, it is important to take the increased capacity need into consideration when sizing the fan system.

Installing a chimney fan

The chimney fan is installed on top of the chimney. The chimney fan is supplied as standard with adjustable location brackets, armoured powercable, a safety wire and a mineral wool mat, which ensures vibration-free operation.

When installing a fan onto a brick chimney the location brackets are fitted under the chimney fan.

If the chimney fan is to be fitted onto a steel chimney, then a flange and vibration dampers must be used instead of location brackets. The flange, which includes vibration dampers, must be ordered separately.

NB! If the chimney has been used previously to a fan being installed, then it should be cleaned before the chimney fan is switched on, thus reducing the risks of a chimney fire.

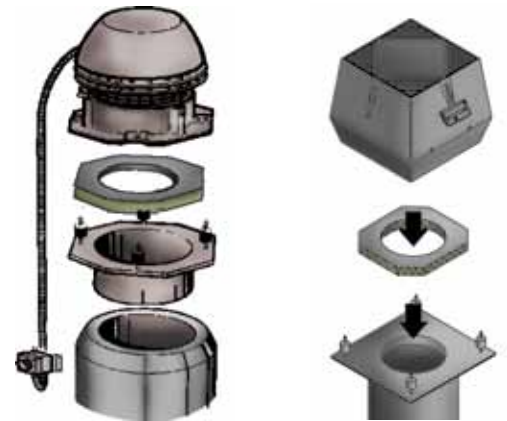
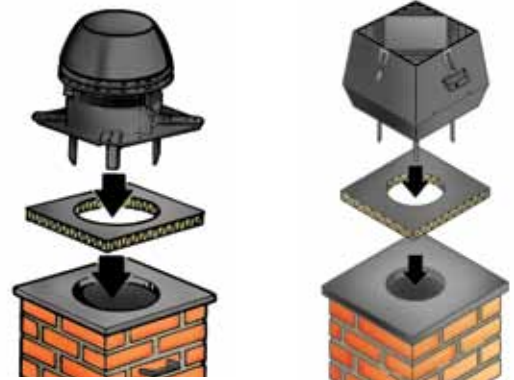

'Hiding' the chimney fan

Installation of **exodraft** chimney fans on top of chimneys can sometimes be difficult due to special site conditions such as listed buildings or special architectural demands. For those installations it is possible to make the fans virtually invisible.

Contact **exodraft** for assistance if such a solution is needed.

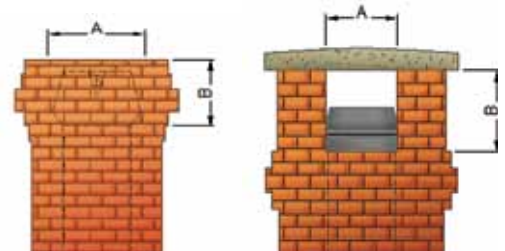

Service and maintenance



The chimney fan should be cleaned as often as needed (at least once a year) depending on the type of fire fuel.

When the fan is open, it is easy to clean it while the chimney is being swept.

The chimney fan must always be running when there is a fire in the fireplace, stove or boiler. **exodraft** provides a two-year manufacturer's warranty. The **exodraft** warranty does not include damage caused by fire.

exodraft's extensive product range is based on more than 50 years of experience and knowledge in the field of combustion and chimney draft technology. Our products are known for high safety and quality and we are helping to set the standards and requirements for draft technology.

exodraft products are all fully documented in accordance with current national and international standards and are sold in more than 40 countries – for small domestic fireplaces in private homes to larger commercial and industrial boiler installations.

exodraft
– formerly known as EXHAUSTO Ltd.



Solid fuel and wood-burning stoves and fireplaces



Decentralized multiple fireplaces connected to same chimney



Solid fuel and bio-fuel boilers (pellets etc.)



Gas fireplaces



Oil and gas boilers



Decentralized multiple heating appliances connected to same chimney



Bakeries



Industry



Restaurants and pubs

exodraft
CHIMNEY DRAFT TECHNOLOGY

DK: exodraft

C. F. Tietgens Boulevard 41
DK-5220 Odense SØ
Tel: +45 7010 2234
Fax: +45 7010 2235
info@exodraft.dk
www.exodraft.dk

NO: exodraft

Fjordgløttveien 11
NO-3060 Svelvik
Tel: +47 3329 7062
Fax: +47 3378 4110
info@exodraft.no
www.exodraft.no

FR: exodraft

75 Ter Rue Chazière
FR-69004 Lyon
Tél: +33 (0)961 490 287
Fax: +33 (0)970 623 061
info@exodraft.fr
www.exodraft.fr

SE: exodraft

Årnäsvägen 25B
SE-432 96 Åskloster
Tlf: +46 (0)8-5000 1520
Fax: +46 (0)340-62 64 42
info@exodraft.se
www.exodraft.se

UK: exodraft

Unit 3, Lancaster Ct.
Cressex Business Park
GB-High Wycombe HP12 3TD
Tel: +44 (0)1494 465 166
Fax: +44 (0)1494 465 163
info@exodraft.co.uk
www.exodraft.co.uk

DE: exodraft

Niederlassung Deutschland
Rosengartenstr. 9
DE-55569 Monzingen
Tel: +49 (0)6751 855 599-0
Fax: +49 (0)6751 855 599-9
info@exodraft.de
www.exodraft.de